

**N  
EM**

**NEWPORT**

**ELECTRIC MOTORS**



# ODP 1/4HP THRU 10HP

## SINGLE PHASE CONTINUOUS DUTY MOTORS

**FEATURES:**

- 60HZ
- NEMA Service Factor 1.15
- Continuous Duty 40°C Ambient
- ODP (Drip Proof) Class F Insulation
- NEMA Design L
- High Starting Torque and Low Starting Current
- Rolled Steel construction
- Ball Bearings
- Capacitor Start (1/4HP thru 1.5HP)
- Capacitor Start/Capacitor run (2HP thru 10HP)

**APPLICATIONS:**

- Commercial Pumps
- Swimming Pool Pumps
- Fans
- Conveyors
- Air Conditioning Equipment
- Small Machine Tools
- Blowers
- Augers
- Household Electric Appliances
- Requiring Direct Drive High Starting Torque Equipment

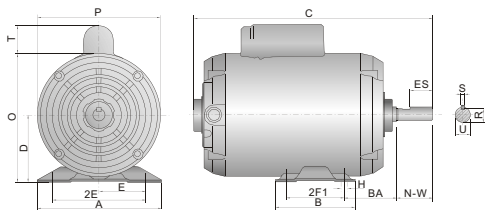

Figure 1

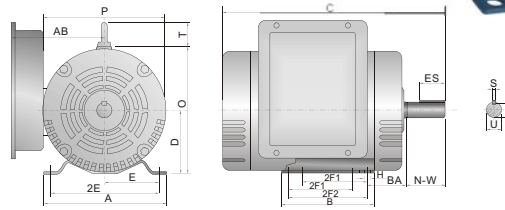

Figure 2

**Overall & Installation Dimensions (Figure 1)**

HP	Frame Size	A	B	C	D	H	BA	2E	2F1	2F2	AB	T	O	P	N-W	U	S	R	ES
1/4	48	6.54	4.20	10.00	3	0.34	2.50	4.24	2.75	—	—	1.5	5.8	5.59	1.50	0.500	—	0.453	—
1/3	48	6.54	4.20	10.70	3	0.34	2.50	4.24	2.75	—	—	1.5	5.8	5.59	1.50	0.500	—	0.453	—
1/2	56	6.54	4.20	11.50	3.5	0.34	2.75	4.88	3.00	—	—	1.5	6.75	6.46	1.88	0.625	0.188	0.517	1.41
3/4	56	6.54	4.20	12.40	3.5	0.34	2.75	4.88	3.00	—	—	1.5	6.75	6.46	1.88	0.625	0.188	0.517	1.41
1	56			12.80															
1 1/2	56H	6.54	6.50	13.00	3.5	0.34	2.75	4.88	5.00	—	—	1.5	6.75	6.46	1.88	0.625	0.188	0.517	1.41

**Overall & Installation Dimensions (Figure 2)**

HP	Frame Size	A	B	C	D	H	BA	2E	2F1	2F2	AB	T	O	P	N-W	U	S	R	ES
2	182T	8.66	6.70	13.80	4.5	0.41	2.75	7.50	4.50	5.50	6.70	1.97	9.25	8.66	2.75	1.125	0.250	0.986	1.78
3	182T			14.60															
5	184T			15.75															
7 1/2	213T	10.45	8.66	17.75	5.25	0.41	3.55	8.50	5.50	7.00	8.66	1.97	10.65	10.25	3.38	1.375	0.312	1.201	2.41
10	215T			19.00															

HP	Full Load RPM	Voltage	NEMA Frame	Model NO.	Current at 230V		Torque		ODP Appox. shipping Weight LB
					Full Load	Locked Rotor	Locked Rotor	Break Down	
1/4	1720	230	48	SCD481/4Z4L	2.3	15	2.9	1.4-2.0	20
1/3	1720	230	48	SCD481/3Z4L	2.8	18	3.6	2.0-2.5	23
1/2	1720	230	56	SCD561/2Z4L	4.5	25	5.3	2.5-3.6	25
3/4	1720	230	56	SCD563/4Z4L	5.2	35	7.5	3.6-5.2	26
1	1725	230	56	SCD561Z4L	6.8	45	9.0	5.2-6.8	29
1 1/2	1725	230	56H	SCD56H1 1/2 Z4L	7.5	50	12.5	6.8-10.1	37
2	1730	230	182T	SLD182T2Z4L	9.0	65	16.0	10.1-13.0	80
3	1730	230	182T	SLD182T3Z4L	13.8	90	22.0	13.0-19.0	92
5	1735	230	184T	SLD184T5Z4L	23.0	135	33.0	19.0-30.0	98
7 1/2	1735	230	213T	SLD213T7 1/2 Z4L	34.0	200	45.0	30.0-45.0	132
10	1735	230	215T	SLD215T10Z4L	45.0	260	52.0	45.0-60.0	165

# TEFC 1/4HP THRU 10HP

## SINGLE PHASE CONTINUOUS DUTY MOTORS

**FEATURES:**

- 60HZ
- Continuous Duty 40°C Ambient
- TEFC (Totally Enclosed Fan Cooled)
- Class F Insulation
- NEMA Design L
- High Starting Torque and Low Starting Current
- Rolled Steel construction
- Ball Bearings
- Capacitor Start(1/4HP thru 1.5HP)
- Capacitor Start/Capacitor run (2HP thru 10HP)

**APPLICATIONS:**

- Commercial Pumps
- Swimming Pool Pumps
- Fans
- Conveyors
- Air Conditioning Equipment
- Small Machine Tools
- Blowers
- Augers
- Household Electric Appliances
- Requiring Direct Drive High Starting Torque Equipment

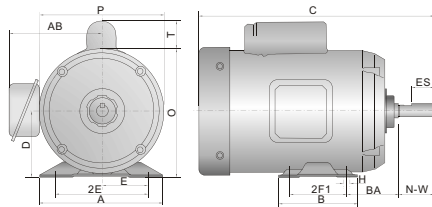

Figure 1

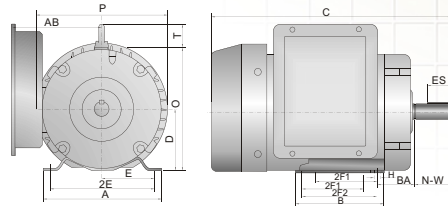

Figure 2

**Overall & Installation Dimensions (Figure 1)**

HP	Frame Size	A	B	C	D	H	BA	2E	2F1	2F2	AB	T	O	P	N-W	U	S	R	ES
1/4	48	6.54	4.20	12.00	3	0.34	2.50	4 24	2.75	—	5.00	1.5	6.20	5 59	1.50	0.500	—	0.453	—
1/3	48	6.54	4.20	12.70	3	0.34	2.50	4 24	2.75	—	5.00	1.5	6.20	5 59	1.50	0.500	—	0.453	—
1/2	56	6.54	4.20	13.50	3.5	0.34	2.75	4 88	3.00	—	5.80	1.5	7.15	6 86	1.88	0.625	0.188	0.517	1.41
3/4	56	6.54	4.20	14.40	3.5	0.34	2.75	4 88	3.00	—	5.80	1.5	7.15	6 86	1.88	0.625	0.188	0.517	1.41
1	56			14.80															
1½	56H	6.54	6.50	15.00	3.5	0.34	2.75	4 88	5.00	—	5.80	1.5	7.15	6 86	1.88	0.625	0.188	0.517	1.41

**Overall & Installation Dimensions (Figure 2)**

HP	Frame Size	A	B	C	D	H	BA	2E	2F1	2F2	AB	T	O	P	N-W	U	S	R	ES
2	182T	8.66	6.70	15.95	4.5	0.41	2.75	7 50	4.50	5.50	6.70	1.97	9.25	9.85	2.75	1.125	0.250	0.986	1.78
3	182T			16.95															
5	184T			18.35															
7½	213T	10.45	8.66	19.88	5.25	0.41	3.55	8 50	5.50	7.00	8.66	1.97	10.65	11.62	3.38	1.375	0.312	1.201	2.41
10	215T			21.26															

HP	Full Load RPM	Voltage	NEMA Frame	Model NO.	Current at 230V		Torque		ODP Approx. shipping Weight LB
					Full Load	Locked Rotor	Locked Rotor	Break Down	
					Amps		LB-FT		
1/4	1720	230	48	SCF481/4Z4L	2.3	15	2.9	1.4-2.0	24
1/3	1720	230	48	SCF481/3Z4L	2.8	18	3.6	2.0-2.5	27
1/2	1720	230	56	SCF561/2Z4L	4.5	25	5.3	2.5-3.6	31
3/4	1720	230	56	SCF563/4Z4L	5.2	35	7.5	3.6-5.2	33
1	1725	230	56	SCF561Z4L	6.8	45	9.0	5.2-6.8	37
1½	1725	230	56	SCF561½Z4L	7.5	50	12.5	6.8-10.1	43
2	1730	230	182T	SLF182T2Z4L	9.0	65	16.0	10.1-13.1	87
3	1730	230	182T	SLF182T3Z4L	13.8	90	22.0	13.0-19.0	97
5	1735	230	184T	SLF184T5Z4L	23.0	135	33.0	19.0-30.0	105
7½	1735	230	213T	SLF213T7½Z4L	34.0	200	45.0	30.0-45.0	140
10	1735	230	215T	SLF215T10Z4L	45.0	260	52.0	45.0-60.0	175